

HS-420S Accelerometer

4-20mA velocity output via 2 Pin MS Connector

Key Features

- For use with PLC/DCS systems
- Side entry for easy access
- Customizable features

Industries

Building services, Pulp and Paper,
Mining, Metals, Utilities, Automotive,
Water, Pharmaceutical

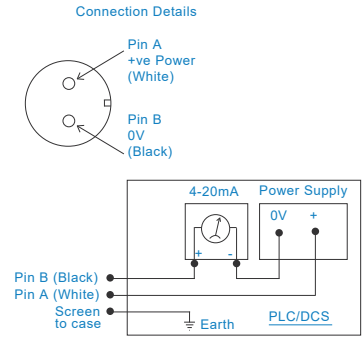
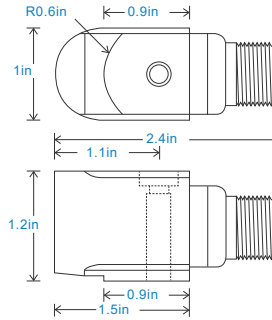

Technical Performance

Mounted Base Resonance	5kHz min
Velocity Ranges	see: 'How To Order' table $\pm 10\%$ Nominal 80Hz at 72°F
Frequency Response	600cpm (10Hz) to 60kcpm (1kHz) $\pm 5\%$ - ISO10816
Isolation	Base isolated
Range	50g peak
Transverse Sensitivity	Less than 5%

Mechanical

Case Material	Stainless Steel
Sensing Element/Construction	PZT/Shear
Mounting Torque	5.9ft. lbs
Mounting Bolt Provided	see: 'How To Order' table x 1.2in long
Weight	6.5 oz. (nominal) body only
Shielded Cable Assembly	see: www.hansfordsensors.com for options
Connector	HS-AA004 - non-booted HS-AA053 or HS-AA054 - booted
Mounting Threads	see: 'How To Order' table

Electrical

Current Output	4-20mA DC proportional to Velocity Range
Supply Voltage	15-30 Volts DC (for 4-20mA)
Settling Time	1 second
Output Impedance	Loop Resistance 600 Ohms max. at 24 Volts
Case Isolation	$>10^8$ Ohms at 500 Volts

Environmental

Operating Temperature Range	-13 to 248°F
Sealing	IP68
Maximum Shock	5000g
EMC	EN61326-1:2013

Typical Frequency Response

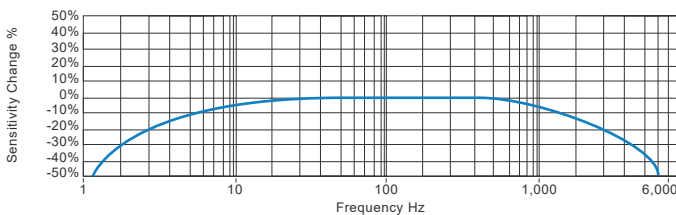

Applications

Fans, Motors, Pumps, Compressors,
Centrifuges, Conveyors, Air Handlers,
Gearboxes, Rolls, Dryers, Presses,
Cooling, VAC, Spindles, Machine Tooling,
Process Equipment

Vibration sensor should be firmly fixed to a flat surface
(spot face surface may be needed to be produced and
cable anchored to sensor body.)

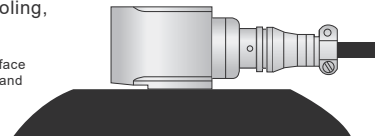

How To Order

Product Prefix		Product Series									
HS - Hansford Sensors		420 - Industrial Vibration Sensor									
H	S	4	2	0	S	X	X	X	X	X	X
Extra Options (if required)					Velocity Range (RMS unless specified)			Cable/Connector		Mounting Threads	
F - Filtered					012 - 1/2 IPS			01 - PUR		02 - 1/4-28" UNF Male	
L - 316L Stainless Steel					025 - 1 IPS			02 - Braided		06 - M6 x 1mm Male	
RT - Temperature Output PT100					050 - 2 IPS			07 - Silicon		08 - M8 x 1.25mm Male	
S - 90° Side Exit					100 - 4 IPS			08 - Flame Retardant			
T - Temperature Output								50 - 2 Pin MS			
								54 - M12			



www.hansfordsensors.com
sales@hansfordsensors.com

We reserve the right to alter the specification of this product without prior notice
TS230U.8

