

HS-CA002 Charge Amplifier

AC acceleration output

Key Features

- Inline

Industries

Test and Measurement,
High Temperature

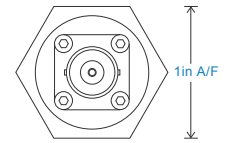
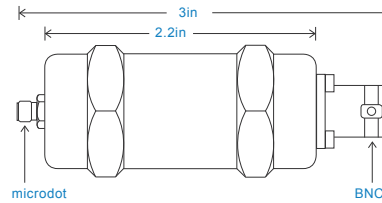

Technical Performance

Sensitivity	1pc/g = 2mV/g (other sensitivities available)
	Max output = 8V
Frequency Response	2Hz to 20kHz
Non-Linearity	<1%
Output	AC on a 12V bias level
Output Impedance	200 ohms

Mechanical

Case Material	Stainless Steel
Input Connector	Microdot
Output Connector	BNC Socket
Weight	3.5 oz. (nominal)

Electrical

DC Supply	18-30 Volts DC
Current Range	0.5mA to 8mA
Settling Time	2 seconds

Environmental

Operating Temperature Range	-67 to 185°F
Sealing	IP65
EMC	EN61326-1:2013

Typical Frequency Response (at 100mV/g)

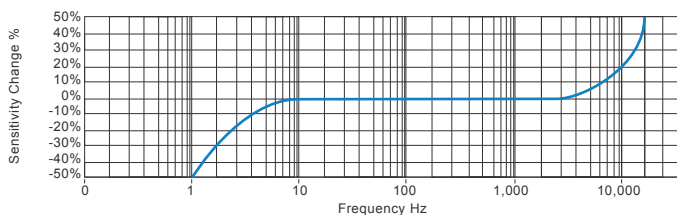

Applications

Feed Pumps, Boilers, Turbines
and Compressors

How To Order

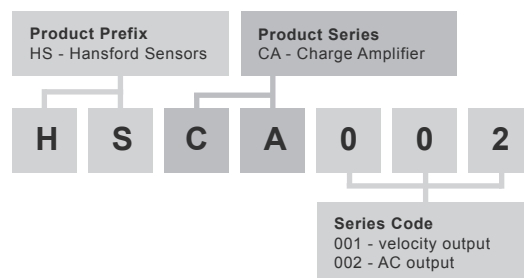

www.hansfordsensors.com
sales@hansfordsensors.com

We reserve the right to alter the specification of this product without prior notice
TS406U.2

